

R302W Weekly Programmable Heating Smart Thermostat

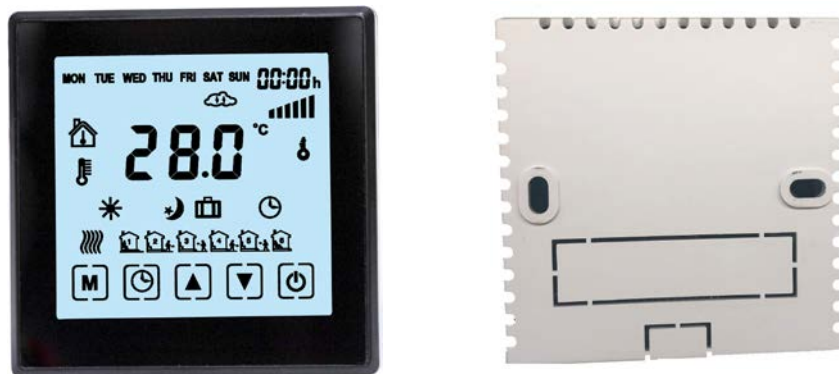

Application

R302W is used to control the room temp. in Heating or Cooling systems. Typically applications include:

- ☞ Homes
- ☞ Residential buildings
- ☞ Schools
- ☞ Offices

It is able to control following equipments or device:

- ☞ Thermal Valves or Zone Valves
- ☞ Combi Boilers
- ☞ Gas or Oil Burners
- ☞ Fans
- ☞ Pumps

Specification

※ Function Diagram

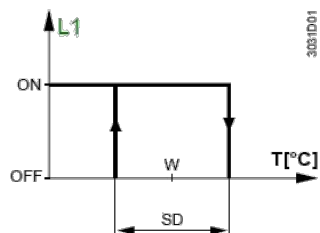

- T** Room Thermostat
- SD** Switching differential (1K)
- W** Room temperature setpoint
- L1** Output Signal for Heating

※ General Information

Casing Material ABS & Acrylic
Power Supply AC100V~AC240V, 50/60 Hz
Power Consumption <1.5W
Current Load R301W GA 3 A
R301W GB 16A
R301W GC 25A
Ambient Temp. Range 0~99°C

Setpoint Range 5~35 °C(ComfortMode)
5~35 °C (Energy Saving Mode)
5 °C~ 35°C(Frost Protection)

Accuracy/Tolerance +/-1°C

Timing Tolerance : <1%

Thermistor : 10K Ω@25 °C

Storage Conditions Temp. -10~60 °C

Humidity:< 90% r.h.

※ Display Icons & Buttons

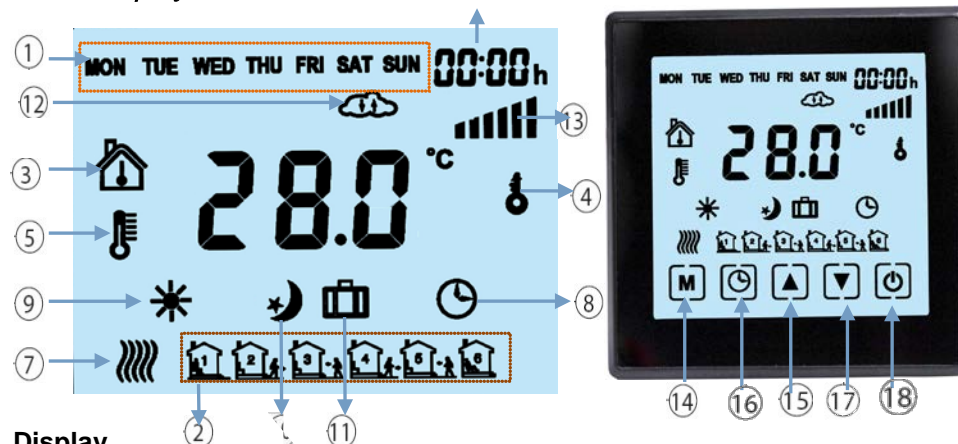

Display

1. Week day: from Monday to Sunday
2. Programmable Time Zone
3. Room Temperature
4. Buttons Lock
5. Setpoint, or Floor Temperature (It displays when external sensor is activated)
6. Time of day(00:00..23:59)

7. Heating is on
8. Automatic Programmable Mode: 7 days, 6 time zones
9. Comfort Mode
10. Energy Saving Mode
11. Holiday Mode
12. Data is communicating
13. Signal Indicator for Network

Buttons

14. Modes selecting.

Selecting Comfort Mode, Energy Saving Mode Automatic Mode, and Holiday Mode

15. Temperature up, or other parameters setting

In case of internal and external sensors are selected, press \wedge button for 3 sec, Setpoint is displaying external sensor's temperature; after 3 sec, it returns to setpoint

16. 7 days Programmable setting

Press and hold this button for 3 seconds, setting sequence is from Hour (6 time zone), Minute(6 time zone) and Setting Temperature(6 time zone) (user can set the value which is flickering).

Mon to Fri 1st time setting (Hour & Minute),
1st setpoint setting.....
6th time setting(Hour & Minute),
6th setpoint setting

Saturday 1st time setting(Hour & Minute),
1st setpoint setting.....
6th time setting(Hour & Minute),
6th setpoint setting

Sunday 1st time setting(Hour & Minute),
1st setpoint setting.....
6th time setting(Hour & Minute),
6th setpoint setting

Decreasing or Increasing value by 10 mins by
△▽ buttons.

Ex-factory Setting

| Weekday Time Zone | 1~5 Mon~ Fri | 6 Sat. | 7 Sun. |
|----------------------|--------------------|-----------|-----------|
| 1 00:00~06:00 | 19°C | 19°C | 19°C |
| 2 06:00~11:30 | 20°C | 20°C | 20°C |
| 3 11:30~16:30 | 20°C | 20°C | 20°C |
| 4 16:30~19:00 | 23°C | 23°C | 23°C |
| 5 19:00~22:30 | 25°C | 25°C | 25°C |
| 6 22:45~00:00 | 22°C | 22°C | 22°C |

17.Temperature down, or other parameters setting **18.** On/off button

Parameters setting

In case of the thermostat is switch off, please press and hold **M** button for 3 seconds

| Code | Parameters | Operated by △▽ button |
|------|-------------------------------------------|-------------------------------------------------------------------------------------------------------------------------------------------------------------|
| 1 | Temp Calibration | -9°C~+9°C(0 °C is defaulted) |
| 2 | Sensors | 0:Single Internal Sensor activate(defaulted) 1:Internal and External sensors activate 2:Single External Sensor activate |
| 3 | On/off Status | 0:Off(thermostat is OFF after power failure is back) (Defaulted) 1:On(thermostat will work the same as before power failure after power failure is back) |
| 4 | Frost Projection activation | 0: Off 1:On(Defaulted) |
| 5 | Setpoint Range of Frost Protection | 3°C~15°C(When it is activated,if room temperature is lower than this setpoint, heating equipments will open up automatically.(5°C is defaulted) |
| 6 | Setpoint Range of Overheating Protection | 35°C~70°C(When room temperature is higher than this setpoint, heating equipments will be cut off automatically.(45°C is defaulted) |
| 7 | Switch-off Temperature Differential range | 0.5°C~3.0°C(when the room temperature is higher than temperature of setpoint plus this deferential setpoint, heating equipment is cut off automatically) |
| 8 | Switch-on Temperature Differential range | 0.5°C~3.0°C (when the room temperature is lower than temperature of setpoint minus this deferential setpoint, heating equipment is activated automatically) |
| 9 | Version# | 103 |

Error Code

Whatever there is something wrong for internal or external sensor, ERR code will be

displayed on time position. Please contact supplier for further information

Wiring Diagram

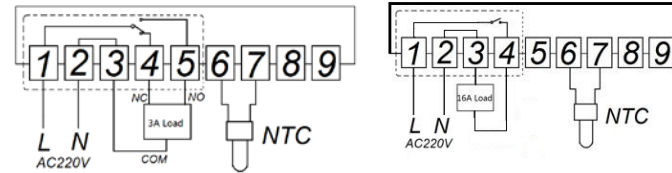

R301 GA

Dimensions

R 301 GB

WARNING: RISK OF ELECTRICALSHOCK.
Disconnect power supply before making electrical connection. Contact with components carrying hazardous voltage can cause electrical shock and may result in severe personal injury or death.

Front(unit:mm)



Thickness (unit:mm)

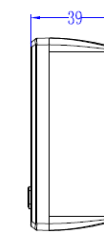

Mounting Hole (unit:mm)

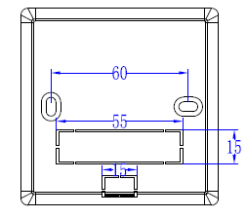

Mounting

Mount the thermostat in location where the air temperature can be measured as accurately as possible without adversely affect by direct solar radiation or other source of heating or cooling.

1st Take off the baseplate from the controller

2nd Fix the baseplate using screwdriver on the wall

3rd Insert and clip the display unit on the baseplate

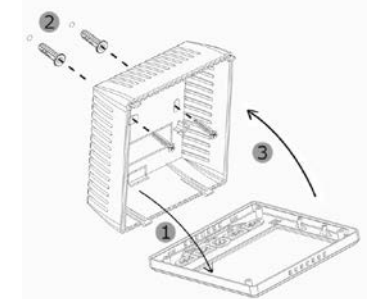

Warranty

We offer warranty of 12 months, from the sales date. If it is not the quality problems, or beyond the warranty period,we will charge for the after-sales services